

making strong connections

Machining

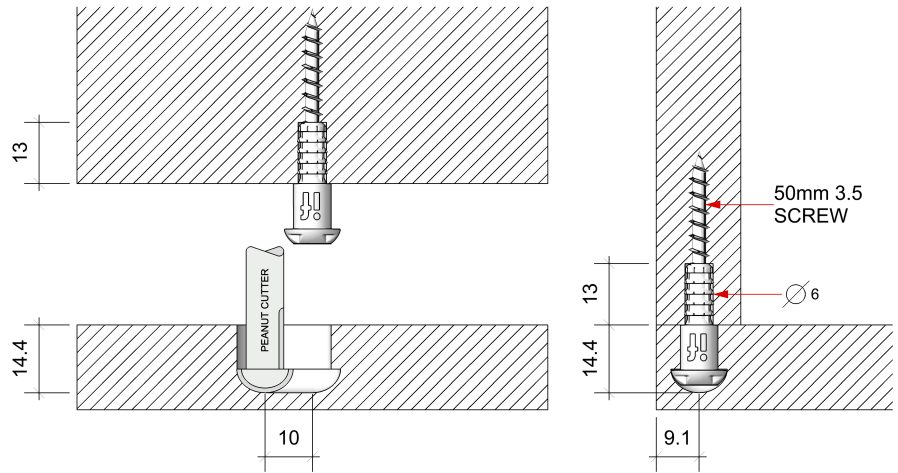

Assembly

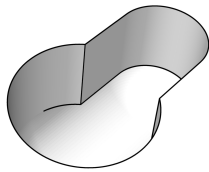
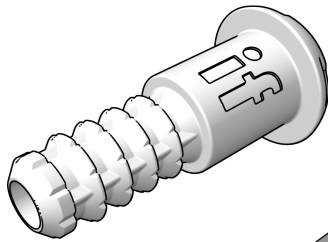
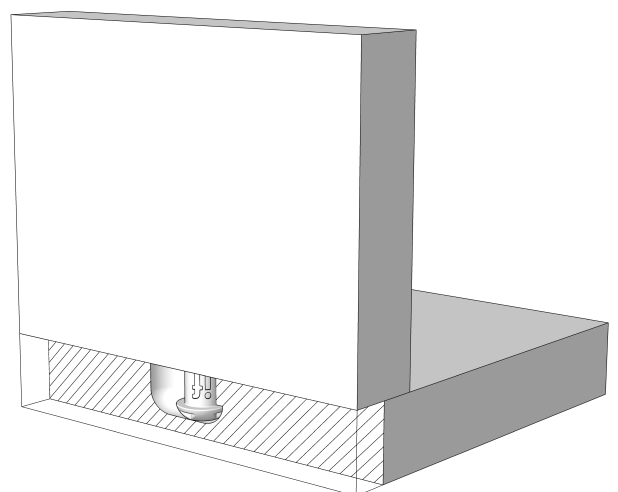
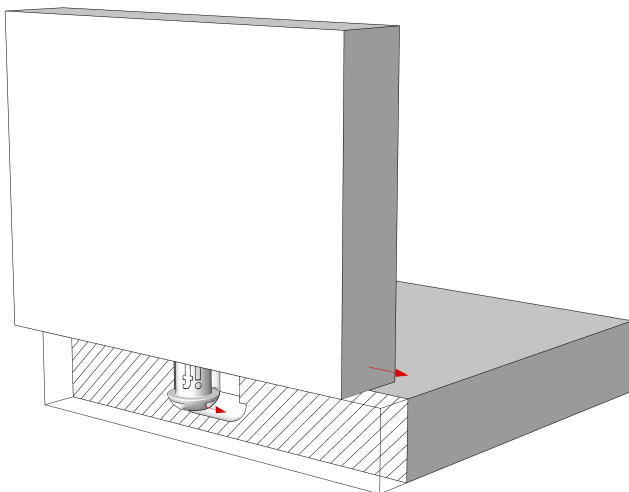
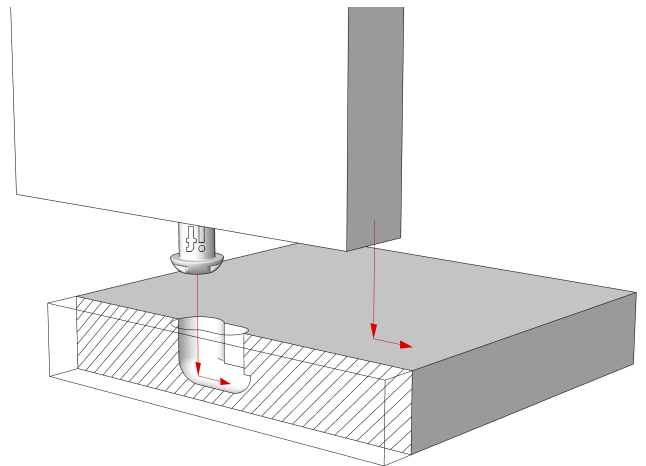
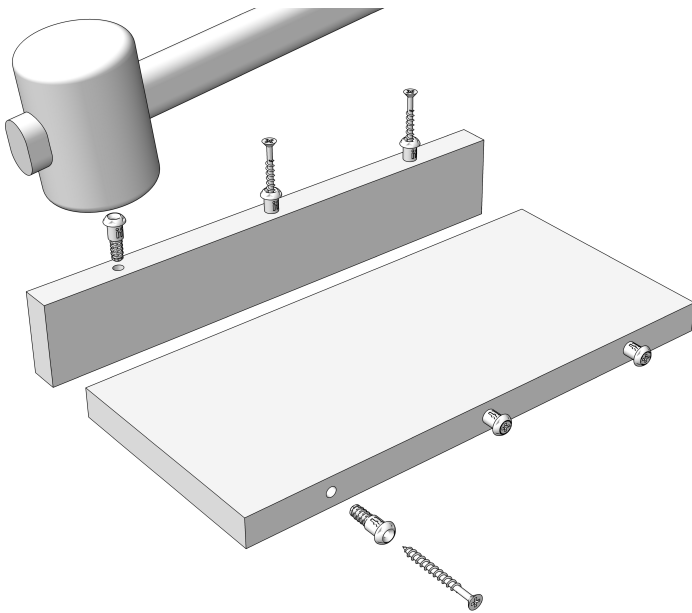

Visit our website for more useful information, news, videos and lots more....

making strong connections

Applications

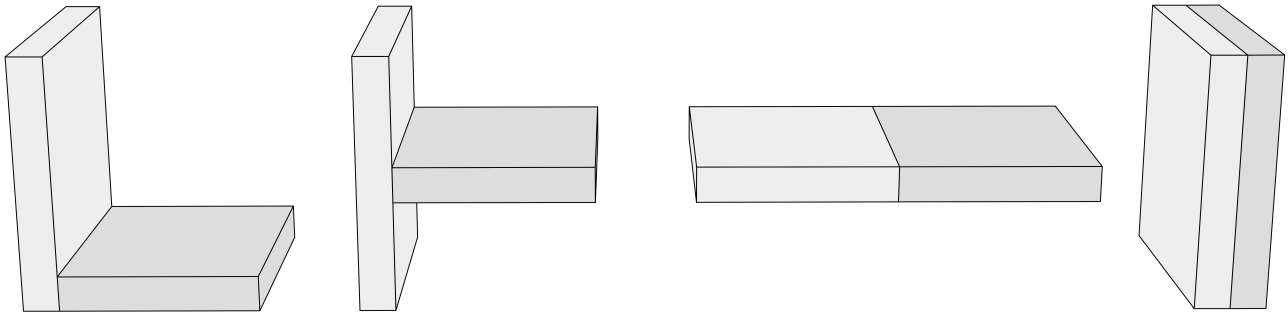

Technical Specification

PEANUT® 2 Technical data

COMPONENT COMPOSITION	GLASS-FIBRE REINFORCED PLASTIC
MATERIAL THICKNESS	>15.3mm
TOLERANCE (PEANUT CUTTER SLOT)	+ 0.7mm - 0.3mm (DEPTH)

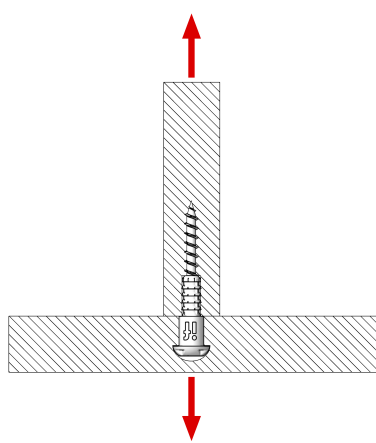

Fig A

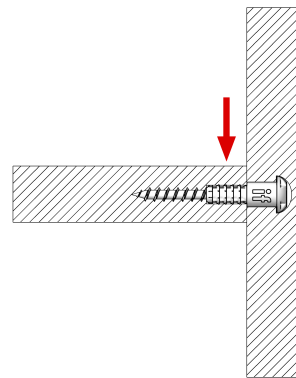

Fig B

PEANUT® 2 Tensile/shear strength (based on 2 components) with a 50mm x 3.5mm counter sunk wood screw

MATERIAL	TENSILE STRENGTH (Fig A)	SHEAR STRENGTH (Fig B)
PARTICLE BOARD (18mm MFC)	1800N 180KG	800N 80KG
MDF (18mm)	3000N 300KG	1300N 130KG

All testing has been carried out in-house (independent testing will be carried out early in 2019)

PEANUT® 2 Tooling requirements

IF SOLID CARBIDE PEANUT CUTTER	MAX RPM 14000	CREATES 6500+ SLOTS (BASED ON MELAMINE FACED PARTICLE BOARD) THIS TOOL CANNOT BE SHARPENED
6mm SOLID CARBIDE DRILL		ANY 6mm DRILL WILL WORK (WE HAVE FOUND A SOLID CARBIDE DRILL GIVES BEST RESULTS)

PEANUT® 2 Other applications

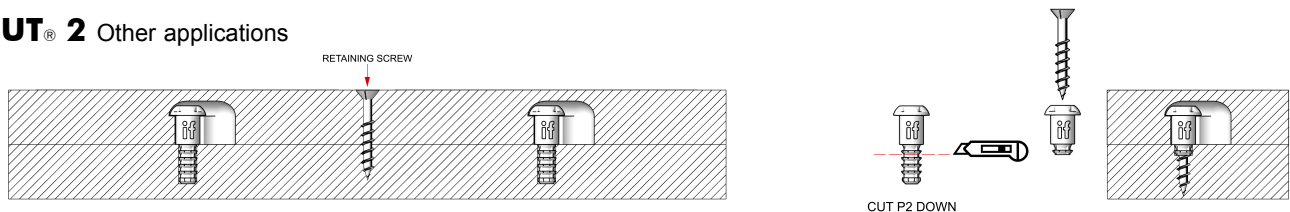

Use the **PEANUT® 2** without the 50mm screw for non-structural location and alignment of drawer fronts, side panels and other work pieces face to face.

Cut down and use with shorter screws for a more permanent face to face solution.

A standard PVA wood glue can be used for added strength and a permanent joint.